

Personal Audio System

Operating Instructions

Getting started

About SongPal

Listening to music through a
BLUETOOTH connection

Listening to music via a Wi-
Fi network

Listening to music with
connected components

Additional information

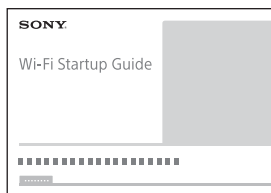

Refer to the Wi-Fi Startup Guide (separate document) for how to listen to music stored in your PC or other device over your Wi-Fi network.

Before operating the system, please read this guide thoroughly and retain it for future reference. To reduce the risk of fire, do not cover the ventilation opening of the appliance with newspapers, tablecloths, curtains, etc. Do not expose the appliance to naked flame sources (for example, lighted candles). To reduce the risk of fire or electric shock, do not expose this apparatus to dripping or splashing, and do not place objects filled with liquids, such as vases, on the apparatus.

Do not install the appliance in a confined space, such as a bookcase or built-in cabinet. Do not expose batteries or apparatus with battery installed to an excessive heat such as sunshine, fire or the like.

As the main plug is used to disconnect the unit from the mains, connect the unit to an easily accessible AC outlet. Should you notice an abnormality in the unit, disconnect the main plug from the AC outlet immediately. The system is not disconnected from the mains as long as it is connected to the AC outlet, even if the system itself has been turned off. Do not subject the unit to a strong shock. The glass may break, and the broken glass may cause injury. If the glass is broken, stop use of the unit immediately. Be careful not to touch the damaged part.

CAUTION

Danger of explosion if battery is incorrectly replaced. Replace only with the same or equivalent type.

Risk of explosion if battery is replaced by an incorrect type. Dispose of used batteries according to the instructions.

Notice for customers: the following information is only applicable to equipment sold in countries applying EU directives

This product has been manufactured by or on behalf of Sony Corporation, 1-7-1 Konan Minato-ku Tokyo, 108-0075 Japan. Inquiries related to product compliance based on European Union legislation shall be addressed to the authorized representative, Sony Deutschland GmbH, Hedelfinger Strasse 61, 70327 Stuttgart, Germany. For any service or guarantee matters, please refer to the addresses provided in the separate service or guarantee documents.

The validity of the CE marking is restricted to only those countries where it is legally enforced, mainly in the countries EEA (European Economic Area).



This product is intended to be used in the following countries:

BE, LU, NL, CH, AL, AM, BA, BG, HR, CZ, HU, Kosovo, MK, MD, ME, RO, RS, SK, SI, DE, FR, CY, GR, PT, ES, IT, DK, FI, IS, NO, SE, PL, EE, LV, LT, IE, GB

Notice for the customers in Europe

Hereby, Sony Corp., declares that this equipment is in compliance with the essential requirements and other relevant provisions of Directive 1999/5/EC. For details, please access the following URL : <http://www.compliance.sony.de/>

5,150 - 5,350 MHz band is restricted to indoor operations only.

This equipment has been tested and found to comply with the limits set out in the EMC regulation using a connection cable shorter than 3 meters.



Disposal of waste batteries and electrical and electronic equipment (applicable in the European Union and other European countries with separate collection systems)

This symbol on the product, the battery or on the packaging indicates that the product and the battery shall not be treated as household waste. On certain batteries this symbol might be used in combination with a chemical symbol. The chemical symbols for mercury (Hg) or lead (Pb) are added if the battery contains more than 0.0005% mercury or 0.004% lead. By ensuring these products and batteries are disposed of correctly, you will help prevent potentially negative consequences for the environment and human health which could otherwise be caused by inappropriate waste handling. The recycling of the materials will help to conserve natural resources.

In case of products that for safety, performance or data integrity reasons require a permanent connection with an incorporated battery, this battery should be replaced by qualified service staff only. To ensure that the battery and the electrical and electronic equipment will be treated properly, hand over these products at end-of-life to the applicable collection point for the recycling of electrical and electronic equipment. For all other batteries, please view the section on how to remove the battery from the product safely. Hand the battery over to the applicable collection point for the recycling of waste batteries. For more detailed information about recycling of this product or battery, please contact your local Civic Office, your household waste disposal service or the shop where you purchased the product or battery.

Precautions

On safety

The nameplate indicating the Sony trademark, model number and electrical rating is located on the bottom exterior of this unit.

The MAC address is located on the bottom exterior of this unit.

MAC1: MAC address of wired network

MAC2: MAC address of Wi-Fi network

- Before operating the unit, be sure that the operating voltage of the unit is identical with that of your local power supply.

On placement

- Do not set the unit in an inclined position.
- Do not leave the unit in a location near heat sources, or in a place subject to direct sunlight, excessive dust, moisture, rain or mechanical shock.

On operation

- Do not insert any small objects, etc., into the jacks or ventilation hole on the rear of the unit. The unit may short out or malfunction.

On cleaning

- Do not use alcohol, benzene, or thinner to clean the cabinet.

Others

- If you have any questions or problems concerning this unit that are not covered in this manual, please consult your nearest Sony dealer.
- When disposing of or giving away this unit, make sure to initialize it to reset all settings to the factory defaults (page 23).

Documents provided

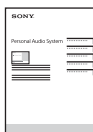

Operating Instructions (this document)

Explains important safety information, BLUETOOTH connection method, troubleshooting, etc.



Wi-Fi Startup Guide (separate document)

Explains how to listen to music stored in your PC or other device over your Wi-Fi network.



Help Guide (web document for a PC/smartphone)

Explains details about the unit; network and BLUETOOTH connection method with various devices, High-Resolution Audio playback method, etc.

http://rd1.sony.net/help/speaker/srs-x99/h_zz/



GB

On copyrights

- Windows, the Windows logo, and Windows Media are either registered trademarks or trademarks of Microsoft Corporation in the United States and/or other countries.
- This product is protected by certain intellectual property rights of Microsoft Corporation. Use or distribution of such technology outside of this product is prohibited without a license from Microsoft or an authorized Microsoft subsidiary.
- Apple, the Apple logo, AirPlay, iPad, iPhone, iPod, iPod classic, iPod nano, iPod touch, iTunes, Mac and OS X are trademarks of Apple Inc., registered in the U.S. and other countries. iPad Air and iPad mini are trademarks of Apple Inc. App Store is a service mark of Apple Inc. “Made for iPod,” “Made for iPhone,” and “Made for iPad” mean that an electronic accessory has been designed to connect specifically to iPod, iPhone, or iPad, respectively, and has been certified by the developer to meet Apple performance standards. Apple is not responsible for the operation of this device or its compliance with safety and regulatory standards. Please note that the use of this accessory with iPod, iPhone, or iPad may affect wireless performance.
-  is a mark of the Wi-Fi Alliance.
- Wi-Fi®, Wi-Fi Protected Access® and Wi-Fi Alliance® are registered marks of the Wi-Fi Alliance.
- Wi-Fi CERTIFIED™, WPA™, WPA2™ and Wi-Fi Protected Setup™ are marks of the Wi-Fi Alliance.
- “S-Master” is a trademark of Sony Corporation.
- ClearAudio+ and ClearAudio+ are trademarks of Sony Corporation.
- “DSEE” and DSEE are trademarks of Sony Corporation.
- MPEG Layer-3 audio coding technology and patents licensed from Fraunhofer IIS and Thomson.
- The BLUETOOTH® word mark and logos are owned by the Bluetooth SIG, Inc. and any use of such marks by Sony Corporation is under license. Other trademarks and trade names are those of their respective owners.
- The N-Mark is a trademark or registered trademark of NFC Forum, Inc. in the United States and in other countries.
- Google Play and Android are trademarks of Google Inc.
- Google Cast™ and the Google Cast Badge are trademarks of Google Inc.
- “Xperia” and “Xperia Tablet” are trademarks of Sony Mobile Communications AB.
- WALKMAN® and WALKMAN® logo are registered trademarks of Sony Corporation.
- LDAC™ and LDAC logo are trademarks of Sony Corporation.
- DLNA™, the DLNA Logo and DLNA CERTIFIED™ are trademarks, service marks, or certification marks of the Digital Living Network Alliance.
- AOSS is a trademark of BUFFALO INC.
- This product incorporates Spotify software which is subject to 3rd party licenses found here: <https://developer.spotify.com/esdk-third-party-licenses/>
- Spotify and Spotify logos are trademarks of the Spotify Group.
- The system names and product names indicated in this manual are generally the trademarks or registered trademarks of the manufacturer.
™ and ® marks are omitted in this manual.

Notes on the License

This product contains software that Sony uses under a licensing agreement with the owner of its copyright. We are obligated to announce the contents of the agreement to customers under requirement by the owner of copyright for the software.

Please access the following URL and read the contents of the license.

<http://rd1.sony.net/help/speaker/sl/15/>



Notice on GNU GPL/LGPL applied software

This product contains software that is subject to the following GNU General Public License (hereinafter referred to as "GPL") or GNU Lesser General Public License (hereinafter referred to as "LGPL"). These establish that customers have the right to acquire, modify, and redistribute the source code of said software in accordance with the terms of the GPL or LGPL supplied. The source code for the above-listed software is available on the Web.

To download, please access the following URL then select the model name "SRS-X99".

URL: <http://oss.sony.net/Products/Linux/>

Please note that Sony cannot answer or respond to any inquiries regarding the content of the source code.

Notes on the update

If you use this unit while connected to the Internet via a wired or Wi-Fi network, the unit can update to the latest software automatically. By updating the software, new features will be added enabling you to experience more convenient and stable use.

If you do not want to automatically update the software, you can disable this function by using the SongPal installed on your smartphone/iPhone.

However, the software may be updated automatically for stable use, etc., even if you disable this function. Also, if you disable this function, you can still update the software manually.

For details about how to set and operate, refer to the Help Guide.

The unit may not be operational while updating.

Disclaimer regarding services offered by third parties

Services offered by third parties may be changed, suspended, or terminated without prior notice. Sony does not bear any responsibility in these sorts of situations.

Table of Contents

Precautions	3
Documents provided	3
On copyrights.....	4

Getting started

Location and function of controls....	7
---------------------------------------	---

About SongPal

What you can do with SongPal	12
------------------------------------	----

Listening to music through a BLUETOOTH connection

Pairing the unit with a BLUETOOTH device and listening to music.....	13
Listening to music by one-touch action (NFC)	15

Listening to music via a Wi-Fi network

Selecting the method of network connection.....	16
Connecting with a PC	16
Listening to the same music from the multiple speakers (SongPal Link function)	18
Listening to an Internet music service (Google Cast).....	18
Listening to an Internet music service (Spotify)	19

Listening to music with connected components

Listening to music on a USB flash drive, etc. (USB-A).....	19
Listening to music on a high-resolution supported Walkman® and Xperia™ (USB-B)	20
Listening to music on an external device (AUDIO IN).....	20

Additional information

Troubleshooting	21
What is BLUETOOTH wireless technology?	24
Specifications	25

Location and function of controls

This manual mainly explains operations using the buttons on the unit, but the same operations can also be performed using the remote control having the same or similar names.

Unit

Without turning off the power of the unit, place your hand over the center of the top panel (page 8). The backlight lights up and the function buttons are displayed. If no button operation is performed for more than 20 seconds, the button display turns off automatically.

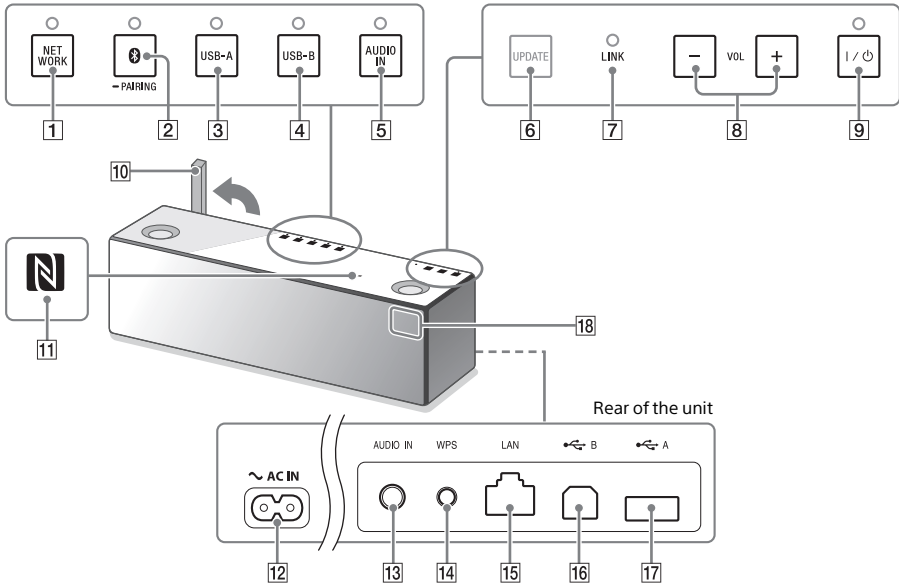

- 1 NETWORK button/indicator**
Tap to switch the unit to NETWORK mode.
Tap to use various music services or listen to music stored in a device on the home network with the unit.
- 2 (BLUETOOTH) - PAIRING button/indicator**
Tap when pairing or connecting with a BLUETOOTH device or listening to music with a BLUETOOTH device.
Tap once to switch the unit to BLUETOOTH mode. Tap and hold to switch the unit to pairing mode.
- 3 USB-A button/indicator**
Tap to listen to music in a device connected to the USB A port (USB-A). The USB-A indicator lights up when tapped.
- 4 USB-B button/indicator**
Tap to listen to music in a device connected to the USB B port (USB-B). The USB-B indicator lights up when tapped.
- 5 AUDIO IN button/indicator**
Tap to listen to music in a device connected to the AUDIO IN jack. The AUDIO IN indicator lights up when tapped.

6 UPDATE button

Indicates the status of the unit's software update.

7 LINK indicator

Indicates the status of the network connection of the unit.

8 VOL (volume) -/+ buttons

Tap to adjust the volume.

The I/⏻ (on/standby) indicator and reaction indicator flash according to the volume adjustment when tapped.

9 I/⏻ (on/standby) button/indicator

Tap to turn the power of the unit on and off.

10 Wi-Fi antenna (aerial)

Set upright during Wi-Fi connection as below.

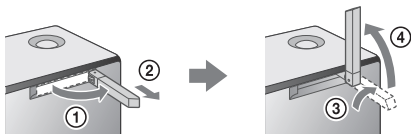

- ① Swing the left side of the antenna (aerial) outwards.
- ② Pull out the antenna (aerial).
- ③ Rotate the antenna (aerial) 90 degrees clockwise.
- ④ Bring up the antenna (aerial).

11 N-Mark

If your smartphone is NFC-compatible, touch the smartphone on the N-Mark. The unit will turn on automatically and registering (pairing) and BLUETOOTH connection can be made.

12 AC IN terminal

Connect the AC power cord (mains lead) (supplied).

13 AUDIO IN jack

Connect to the headphone jack of a portable audio device, etc., using a audio cable (not supplied).

14 WPS button

Press and hold when connecting to a Wi-Fi network.

Beeps will be heard by pressing and holding the WPS button for 2 seconds, which indicates that the unit is ready to connect to a wireless router.

If your wireless router has a WPS button, you can use this button to connect to the network.

15 LAN port

Use a LAN cable (not supplied) to connect the PC or the wireless router.

16 USB B port (B)

Connect a PC using a USB cable (not supplied).

When connecting a high-resolution supported Walkman® or Xperia, use the optional cable.

17 USB A port (A)

Connect a USB flash drive directly. When connecting to an iPhone/iPad/iPod or Walkman®, use the cable supplied with the device.

18 Remote sensor/Reaction indicator

When the unit receives signals from the supplied remote control, the reaction indicator (remote sensor) flashes. Also, the indicator flashes according to the volume adjustment of the unit.

To display the function buttons

Place your hand as illustrated below to display the function buttons (1 to 5). To display quickly, touch the center of the top panel.

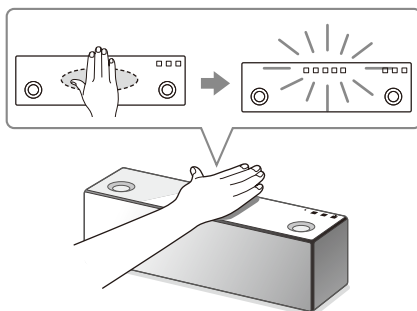

To enjoy more dynamic sound

Remove the speaker grille on the front of the unit with the speaker grille detach tool (supplied).^{*1}

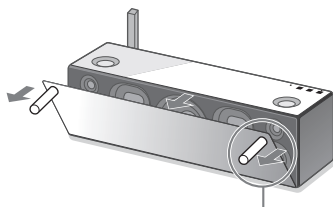

Speaker grille detach tool (supplied)

^{*1} Keep the removed grille on a flat surface to prevent distortion.

When the indicator is lit or flashing

I/⏻ (on/standby) indicator

Indicator status (color)	Unit status
Lights up (green)	The unit is turned on.
Lights up (orange)	The unit is in the BLUETOOTH/Network standby mode.
Turns off	The unit is in the standby mode.
Flashes (green)	<ul style="list-style-type: none"> If you tap the I/⏻ (on/standby) button to turn off the unit, the indicator flashes slowly in green, then lights up in orange or turns off. While the indicator is flashing, the unit is not operational. When you tap the VOL (volume) +/- button, the indicator flashes once or three times according to the volume adjustment.
Flashes (red)	A software update is failed, or the unit is in the protect mode. See "I/⏻ (on/standby) indicator is flashing red" (page 22) for details.

LINK indicator

Indicator status (color)	Unit status
Lights up (orange)	The unit is connected to a Wi-Fi network.
Lights up (pink)	The unit is connected to a wired network.
Flashes (orange)	The unit is in the process of connecting to a Wi-Fi network.
Flashes (pink)	The unit is in the process of connecting to a wired network.
Flashes (red)	The network connection failed.
Lights up (red)	The network connection failed, or connection failed even though the network setting is complete.

The color of the lit/flashing indicator changes depending on the connected music service.

► Refer to Help Guide for details.

http://rd1.sony.net/help/speaker/srs-x99/h_zz/



Ⓛ (BLUETOOTH) – PAIRING indicator

Indicator status (color)	Unit status
Lights up (white)	The unit is connected to a BLUETOOTH device.
Flashes quickly (white)	The unit is pairing with a BLUETOOTH device.
Flashes (white)	The unit is searching for a BLUETOOTH device to connect.

NETWORK indicator

Indicator status (color)	Unit status
Lights up (white)	The unit is in the NETWORK mode.
Flashes (white)	The unit is receiving an audio file via the network.

UPDATE button

Indicator status (color)	Unit status
Lights up (orange)	The button lights up in orange when the unit detects the latest software while connected to the Internet. When you tap and hold the lit button, the update of the unit's software is started.
Flashes (orange)	<ul style="list-style-type: none">• The unit is updating the software. During the update, you cannot operate the unit.• When the unit turns on for the first time after the software update, the UPDATE button flashes three times to inform you that the update is completed.

Remote control

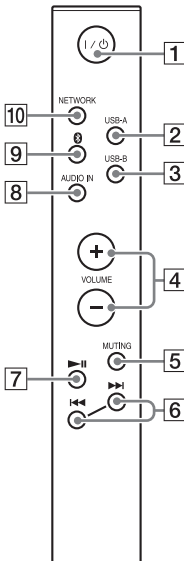

1 I/⏻ (on/standby) button

Press to turn the power of the unit on and off.

2 USB-A button

Press to listen to music in a device connected to the USB A port (🔌A).

3 USB-B button

Press to listen to music in a USB device connected to the USB B port (🔌B).

4 VOLUME +/- buttons

Press to adjust the volume. The VOLUME + button has a tactile dot. Use it as a guide for operation.

5 MUTING button

Press once to mute the sound. Press once again to resume the sound.

6 ◀▶ (Previous/Next) button

Press to operate a connected device while playing back music. Operation is not possible if the device is connected to the USB B port (🔌B) or AUDIO IN jack. Press once to play back the previous/next track.

This function may not be available depending on the device.

7 ▶|| (Play/Pause) button

Press to operate a connected device while playing back music.

Operation is not possible if the device is connected to the USB B port (🔌B) or AUDIO IN jack.

During playback, press once to pause; during pause, press once to resume playback.

This function may not be available depending on the device.

8 AUDIO IN button

Press to listen to music in a device connected to the AUDIO IN jack.

9 📶 (BLUETOOTH) button

Press to pair or connect with a BLUETOOTH device or to listen to music in a BLUETOOTH device.

10 NETWORK button

Press when listening to music stored in a device on the home network using the unit.

To insert the batteries

Insert the two supplied R03 (size AAA) batteries, **+** side first, matching the polarities shown below.

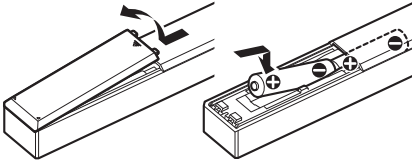

Note

- Do not attempt to charge the batteries.
- If battery leakage occurs, remove any leaked fluid in the battery compartment, and replace the batteries with new ones.
- Strong light, such as lighting equipment or direct sunlight, may affect remote control operation. The remote control may not work.
- The batteries should be replaced within every 6 months. If you find it difficult to operate the remote control, replace both batteries with new ones.

About SongPal

What you can do with SongPal

SongPal is an application for controlling Sony audio devices which are compatible with SongPal using your smartphone/iPhone.

Search for SongPal on Google Play™ or the App Store, and download it.



Downloading this application on your smartphone/iPhone provides the following.

Sound settings of SRS-X99

You can easily customize your sound, or use Sony's recommended settings "ClearAudio+" and "DSEE HX".

Music service*

You can configure the initial settings to use music services. To enjoy music services, a third party application is required.

Controlling devices on your home network

You can play music stored in your PC or home network server over your network.

Controlling a device connected via USB

You can play music in a device connected to the USB A port of SRS-X99.

► Refer to Help Guide for detailed operation.

http://rd1.sony.net/help/speaker/srs-x99/h_zz/



* Depending on the country and region, music services and their period of availability may

differ.

A separate registration is required for certain services. An update of the device may be required.

The services provided by third parties may change, stop or be terminated without notice. Sony does not assume any responsibility for such situations.

What you can control with SongPal varies depending on the connected device. The specification and design of the application may change without notice.

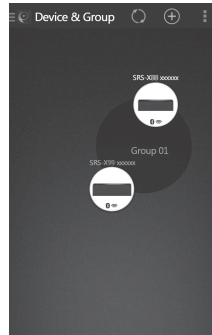

The overview of the devices on the home network is displayed.

You can select the audio device to play or group the audio devices using SongPal Link (multi-room function).

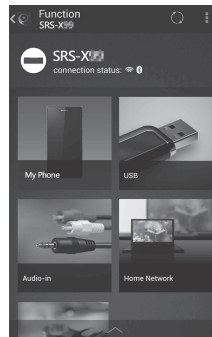

You can select sound sources for playback from the list of the selectable sound sources. Also, you can make various sound/network settings of audio device.

► Refer to SongPal Help for more details.
<http://info.songpal.sony.net/help/>



Listening to music through a BLUETOOTH connection

Pairing the unit with a BLUETOOTH device and listening to music

You can listen to music from BLUETOOTH device over a wireless connection. Before using the BLUETOOTH function, perform pairing to register your BLUETOOTH device.

Note

- When pairing the unit with a BLUETOOTH device, place the BLUETOOTH device within one meter of the unit.
- If your BLUETOOTH device is compliant with one-touch connection (NFC), skip the next procedure. See "Listening to music by one-touch action (NFC)" (page 15).





1 Turn on the unit.

The I/⏻ (on/standby) indicator lights up in green.

2 Tap the (BLUETOOTH) - PAIRING button.

The  (BLUETOOTH) indicator begins to flash in white.

Tip

- From the factory, pairing information is not stored in the unit. As such, when you tap the  (BLUETOOTH) - PAIRING button, the  (BLUETOOTH) indicator will begin to flash quickly in white and the unit enters pairing mode automatically. In this case, proceed to step 4.
- When you tap the  (BLUETOOTH) - PAIRING button, the unit tries to make BLUETOOTH connection with the last connected BLUETOOTH device. If the device is nearby, the BLUETOOTH connection is established automatically and the  (BLUETOOTH) indicator stays lit. When you want to connect another BLUETOOTH device, terminate the current BLUETOOTH connection by operating the currently connected BLUETOOTH device.

3 Tap and hold the (BLUETOOTH) - PAIRING button until beeps are heard.

The  (BLUETOOTH) indicator begins to flash quickly in white, and the unit enters pairing mode.

4 Perform the pairing procedure on the BLUETOOTH device to detect the unit.

When a list of detected devices appears on the display of the BLUETOOTH device, select "SRS-X99".

If passkey entry is required on the display of the BLUETOOTH device, enter "0000".

Note

Stop playback on the BLUETOOTH device before performing the pairing procedure. Loud sound may be output when the BLUETOOTH connection is established. In addition, after the connection is established, loud sound may be output at the time of the first playback operation. It is recommended to turn down the volume before starting playback.

5 Make the BLUETOOTH connection from the BLUETOOTH device.

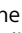
When the BLUETOOTH connection is established, the  (BLUETOOTH) indicator stays lit.

If the BLUETOOTH connection is not established, repeat from step 3.

6 Adjust the volume on the BLUETOOTH device, or tap the VOL (volume) -/+ button to adjust the volume.

7 Start playback on the BLUETOOTH device.

Tip

- You can perform a pairing operation or attempt to make a BLUETOOTH connection with another BLUETOOTH device while the BLUETOOTH connection is established with one BLUETOOTH device. The currently established BLUETOOTH connection is canceled when BLUETOOTH connection with another device is successfully established.
- SongPal does not have a music playback function via the BLUETOOTH connection. Play music using the music playback software of BLUETOOTH devices (such as smartphone, PC, etc.).

Note

- The operations described above may not be available for certain BLUETOOTH devices. In addition, the actual operations may differ depending on the connected BLUETOOTH device.
- Pairing mode of the unit is released after about 5 minutes and the  (BLUETOOTH) indicator flashes slowly. However, when pairing information is not stored in the unit, such as from the factory, pairing mode is not released. If pairing mode is released before finishing the process, repeat from step 3.
- When pairing with a BLUETOOTH device that cannot display a list of detected devices or that has no display, you may pair the device by setting both the unit and the BLUETOOTH device to pairing mode. At this time, if a passkey other than "0000" is set on the BLUETOOTH device, pairing cannot be done with the unit.
- Once a pairing operation is performed, it does not have to be performed again. In the following cases, however, a pairing operation must be performed again:
 - Pairing information was erased when the BLUETOOTH device was repaired.
 - You attempt to pair the unit with more than 9 BLUETOOTH devices.
This unit can pair with up to 9 BLUETOOTH devices. If you pair another BLUETOOTH device after pairing with 9 devices was performed, pairing information of the device that was connected with the unit first is overwritten with that of the new device.
 - Pairing registration information of this unit is erased from the connected device.
 - If you initialize the unit, all the pairing information will be erased.
- The unit can be paired with multiple devices, but can only play music from one paired device at a time.
- "Passkey" may be called "Passcode," "PIN code," "PIN number" or "Password," etc.

To cancel the connection with the BLUETOOTH device

Disconnect the BLUETOOTH connection on the BLUETOOTH device.

Tip

When you finish playing music, the BLUETOOTH connection may terminate automatically, depending on the BLUETOOTH device.

Listening to music through a registered device

After step 2 on "Pairing the unit with a BLUETOOTH device and listening to music" (page 13), operate the BLUETOOTH device to connect with the unit. After adjusting the volume on the BLUETOOTH device, start playback on the BLUETOOTH device.

Tip

Stop playback on the BLUETOOTH device before connecting the unit to the BLUETOOTH device.

Listening to music by one-touch action (NFC)

NFC is a technology for short-range wireless communication between various devices such as a mobile phone and IC tag. Just touch your smartphone on the unit. The unit is turned on automatically, and pairing and BLUETOOTH connection are established.

Beforehand, turn the NFC settings to on and unlock the screen of the smartphone.

disconnected and the unit is connected with the smartphone.

1 Touch your smartphone on the N-Mark on the unit.

Touch the smartphone on the unit and maintain contact until the smartphone responds.

Refer to the user's guide of your smartphone for the part of your smartphone used as touch contact.

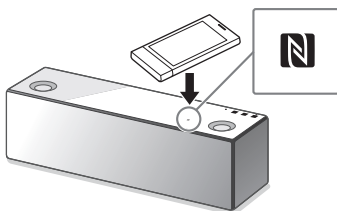

Follow the on-screen instructions to establish the connection.

When a BLUETOOTH connection is established, the  (BLUETOOTH) indicator stops flashing and stays lit.

2 After completing the connection, start playback on the smartphone.

To disconnect the established connection, touch your smartphone on the N-Mark on the unit.

Tip

When you touch an NFC-compliant smartphone on the unit while another BLUETOOTH device is connected with this unit, the BLUETOOTH device is

Listening to music via a Wi-Fi network

Selecting the method of network connection

If you connect this unit to a network, you can enjoy this unit in various ways. Depending on your network environment, setting up methods are different. Select the appropriate connecting method for your network environment from below.

Tip

For setting the fixed IP address, use the screen in step 6 of "Connecting with a PC" (page 16).

Note

Connecting to a Wi-Fi network and a wired network simultaneously is not possible. When you connect to a Wi-Fi network, be sure to disconnect the LAN cable from the unit.

Method for using a smartphone/iPhone

Install the SongPal application for your smartphone/iPhone. For details, refer to the Wi-Fi Startup Guide (separate document).

Method for using a wireless router with a WPS (AOSS) button

Use the WPS button to connect. For details, refer to the Wi-Fi Startup Guide (separate document).

Method for using a PC

See "Connecting with a PC" (page 16).

Method for using a wired network

► Refer to Help Guide for details.

http://rd1.sony.net/help/speaker/srs-x99/h_zz/



Connecting with a PC

If your wireless router does not have a WPS (AOSS) button, configure Wi-Fi settings by connecting the unit to your PC with a LAN cable.

Prepare a commercially-available LAN cable beforehand.

Tip

When setting up a Wi-Fi network, the SSID (Wi-Fi Network Name) and security key (WEP or WPA key) may be required. The security key (or network key) uses encryption to limit the devices with which communication can occur. It is used to provide higher security for devices communicating via a wireless router/access point.

1 Record the SSID and password of your router.

For details, refer to the operating instructions of your router.

SSID (Wi-Fi Network Name)

Password (Security Key)

2 Connect the unit to the PC with a LAN cable directly.

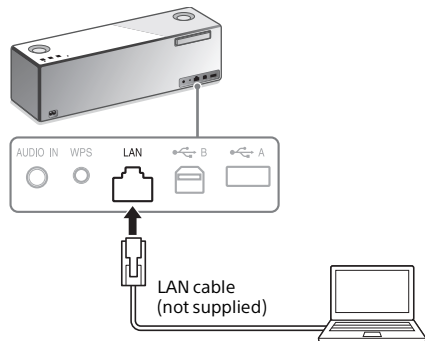

Use a commercially-available LAN cable to connect.

- 3** Turn on the unit.
Wait until the LINK indicator stops flashing and stays lit in pink. It takes about 1 minute.

Note

When you connect the unit to a PC for the first time, it takes about 4 or 5 minutes until the LINK indicator stops flashing and stays lit.

- 4** Display [Sony Network Device Settings] on your PC.

- ① Launch a browser.
- ② Enter the following URL in the address bar.

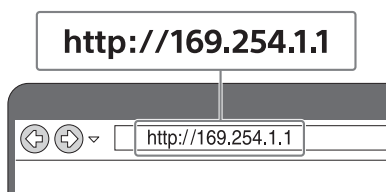

The above URL is only for when the PC and unit are connected with a LAN cable.

- 5** Select [Network Settings] from the menu.

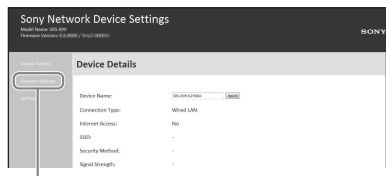

Network Settings

- 6** Select the SSID of your wireless router and enter the password.

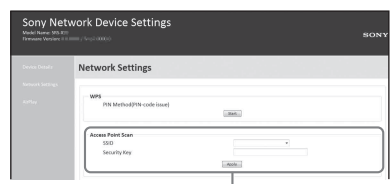

SSID

See the recorded password in step 1 (page 16).

- 7** Select [Apply].

- 8** When prompted, unplug the LAN cable from the unit.

- 9** Check that the LINK indicator lights up in orange.
Set the Wi-Fi antenna (aerial) (page 8).
When the Wi-Fi connection is established, the LINK indicator lights up in orange.
It may take more than 1 minute to light up.

For information on how to listen to music with this unit, refer to the Wi-Fi Startup Guide (separate document).

Listening to the same music from the multiple speakers (SongPal Link function)

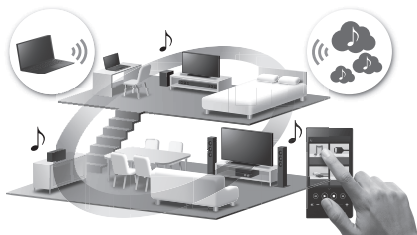

Enjoy music in any room via Wi-Fi. You can listen to your favorite music stored in your PCs or mobile phones and furthermore, music from streaming services, in different rooms with ultimate sound quality.

1 Install the free application SongPal on your smartphone/iPhone.

2 Connect the unit and smartphone/iPhone to your Wi-Fi network.

Connect the unit and smartphone/iPhone to the same SSID (network) of your router.

3 When connecting multiple devices, connect the SongPal Link compatible devices to your Wi-Fi network.

► Refer to Help Guide for detailed operation.

http://rd1.sony.net/help/speaker/srs-x99/h_zz/



Listening to an Internet music service (Google Cast)

The following instructions explain how to use a Google Cast-enabled music app.

1 Install the free application SongPal on your smartphone/iPhone.

2 Connect the unit and smartphone/iPhone to your Wi-Fi network.

Connect the unit and smartphone/iPhone to the same SSID (network) of your router.

3 Launch SongPal, and download a Google Cast-enabled music app.

① Launch SongPal, then tap [SRS-X99] → [Settings] → [Google Cast] → [Learn how to cast].

② See the instructions, then find and install a Google Cast-enabled app on your smartphone/iPhone.

4 Launch the Google Cast-enabled app, then tap the Cast button to select [SRS-X99].



5 Select music to listen to on your Google Cast-enabled app.

The music is played on the unit.

► Refer to Help Guide for detailed operation.

http://rd1.sony.net/help/speaker/srs-x99/h_zz/



Listening to an Internet music service (Spotify)

“Spotify” gives you instant access to millions of songs. The “Spotify Connect” feature lets you select music on the Spotify App and stream it on the unit. To use “Spotify Connect” feature, you need a Premium account.

For details, visit www.spotify.com/connect

- 1 Connect the unit and smartphone/iPhone to your Wi-Fi network.

Connect the unit and smartphone/iPhone to the same SSID (network) of your router.

- 2 Download the Spotify App to your smartphone/iPhone from Google Play or the App Store.

- 3 Launch the Spotify App and log in to a Spotify Premium account.

- 4 Select and start playing the music.

- 5 Tap the Connect icon (🔗) and select the unit as the audio output device.



Tip

When “Spotify Connect” is activated, the Connect icon (🔗) lights up.

Note

Depending on the country and region, music services and their periods of availability may differ.

Listening to music with connected components

Listening to music on a USB flash drive, etc. (USB-A)

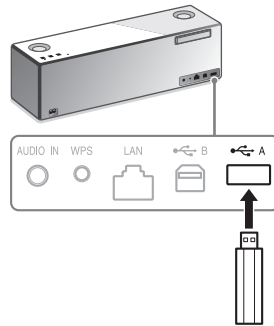

- 1 Connect a USB flash drive, Walkman®, or iPhone/iPad/iPod to the USB A port (🔗 A).

- 2 Tap the USB-A button, then press the ▶|| (Play/Pause) button on the remote control or start playback on the connected device.

▶ Refer to Help Guide for detailed operation.

http://rd1.sony.net/help/speaker/srs-x99/h_zz/



Listening to music on a high-resolution supported Walkman® and Xperia™ (USB-B)

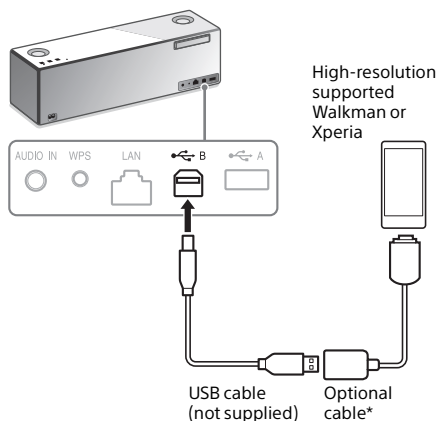

* Optional High-Resolution Audio USB Adaptor WM-PORT Cable can be ordered from your nearest Sony Service Center. To connect Xperia, use a commercially available cable.

1 Connect a high-resolution supported Walkman® or PC to the USB B port (🔌 B).

2 Tap the USB-B button, then start playback on the connected device.

▶ Refer to Help Guide for detailed operation.

http://rd1.sony.net/help/speaker/srs-x99/h_zz/



Listening to music on an external device (AUDIO IN)

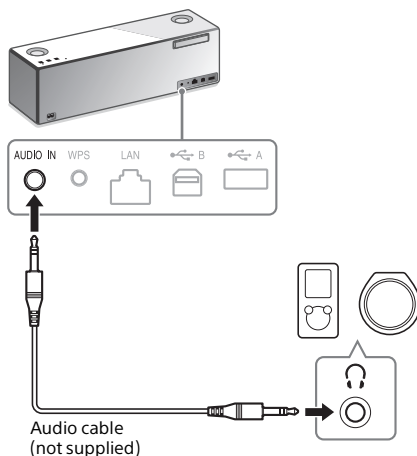

1 Connect the device to the AUDIO IN jack with an audio cable (not supplied).

2 Tap the AUDIO IN button, then start playback on the connected device.

▶ Refer to Help Guide for detailed operation.

http://rd1.sony.net/help/speaker/srs-x99/h_zz/



Additional information

Troubleshooting

If a problem occurs while operating the unit, check the following to resolve the problem before consulting your nearest Sony dealer.

- Check to see if the problem is listed in this “Troubleshooting” section.
- Check in Help Guide.
 - ▶ Refer to “How to use” and “Troubleshooting” in Help Guide for details.

http://rd1.sony.net/help/speaker/srs-x99/h_zz/





- Check information about the problem on the customer support website.
<http://www.sony.eu/support>
- Unplug the AC power cord (mains lead) wait a while and plug the AC power cord (mains lead) again.

If the problem persists after doing all of the above, consult your nearest Sony dealer.

BLUETOOTH

Unable to pair the unit with a BLUETOOTH device/
BLUETOOTH connection between the unit and smartphone/iPhone is not possible using SongPal

- ➔ Bring the unit and the BLUETOOTH device to within 1 m (3 ft) of each other.
- ➔ If the  (BLUETOOTH) indicator is not flashing quickly in white, tap and hold the  (BLUETOOTH) - PAIRING button until the unit beeps and the  (BLUETOOTH) indicator starts flashing quickly in white.
- ➔ If you initialize the unit, the unit may not be able to connect your iPhone/iPad/iPod or PC. In this case, erase the pairing information on the iPhone/iPad/iPod or PC, and then perform the pairing procedure again.

Unable to connect the unit to a BLUETOOTH device with one-touch connection (NFC)

- ➔ Keep the smartphone close to the unit until the smartphone responds. If the unit fails to connect, move the smartphone slowly on the N-Mark of the unit. When the smartphone responds, follow the on-screen instructions to establish the connection.
- ➔ Check that the NFC function of the smartphone is set to on.
- ➔ If the smartphone is in a case, remove it.
- ➔ NFC reception sensitivity varies, depending on the device. If you repeatedly fail to connect the unit with a smartphone by one touch, make the connection by on-screen operation.
- ➔ Check that your smartphone is compatible with NFC. Look up information on the issue on the customer support website.

There is no sound

- ➔ If you are connecting a PC to the unit, make sure the audio output setting of the PC is set for a BLUETOOTH device.
- ➔ Check that the unit has established BLUETOOTH connection with the BLUETOOTH device.
- ➔ Pair the unit and the BLUETOOTH device again.
- ➔ Super tweeter (top) is the playback unit for high-frequency content only. If the music file does not contain the high-frequency content, the sound is not output.

Distorted sound/humming or noise in the speaker output

- ➔ Bring the unit and the BLUETOOTH device closer together. Remove any obstacles between the unit and the BLUETOOTH device.
- ➔ Select “Priority on stable connection” for BLUETOOTH audio streaming playback quality.

Network

A Wi-Fi connection between the unit and home network is not possible

- ➔ The unit does not support IEEE 802.11ac. Use the 2.4 GHz frequency band (IEEE 802.11 b/g/n) or 5 GHz frequency band (IEEE 802.11 a/n) for the Wi-Fi network.
- ➔ When setting a Wi-Fi network using the SongPal application on your smartphone/iPhone, connect your smartphone/iPhone to the Wi-Fi network to be used beforehand.

- ➔ If a LAN cable is connected to the unit, disconnect it and restart the unit. When a LAN cable is connected to the unit, the unit automatically tries to connect to the home network over a wired network and a wireless network cannot be used.
- ➔ Check that your wireless router is turned on.
- ➔ Bring the unit and wireless router closer together. Devices that use the 2.4 GHz frequency band, such as a microwave oven, BLUETOOTH or digital cordless device, etc., may interrupt Wi-Fi communication. Move the unit away from such devices or turn them off.
- ➔ Set the Wi-Fi antenna (aerial).
- ➔ If a Wi-Fi network is not possible even if the setting of a Wi-Fi network is correct, try the following.
 - Turn off the wireless router/access point, wait a while and turn on the power again.
 - Turn off the unit, wait a while and turn on the power again.

Distorted sound/humming or noise in the unit output

- ➔ Turn down the volume of the connected device.
- ➔ If a connected device has an equalizer function, turn it off.
- ➔ Keep the unit away from a microwave oven, other wireless devices, etc.
- ➔ Keep the unit away from metal objects.
- ➔ Connect the unit and wireless router/PC via a LAN cable, not via Wi-Fi network.

No sound/low sound level

- ➔ Check that both the unit and connected device are turned on.
- ➔ Turn up the volume of the unit and the connected device.
- ➔ Check that the connected device is being played back.

iTunes cannot find the unit via AirPlay

- ➔ Make sure the PC with iTunes installed and the unit are connected to the same home network.
- ➔ Update the software version of iTunes to the latest version.

General

I/⏻ (on/standby) indicator is flashing red

- ➔ A software update is failed, or the unit is in the protect mode. Check the following to resolve the problem.
 - The UPDATE button is flashing in orange. Software update is failed. Update the software using a USB flash drive. Check the customer support website about how to update the software with a USB flash drive. Turn off the unit until you perform the software update.
 - The unit does not turn off by tapping the I/⏻ (on/standby) button. The unit is in the protect mode. Unplug the AC power cord of the unit, and unplug all other items connected to the unit. Then, plug the AC power cord in again and turn on the unit. If the I/⏻ (on/standby) indicator keeps flashing, consult your nearest Sony dealer or the shop where you purchased this unit.

The last setting is not kept

- ➔ If the AC power cord (mains lead) is disconnected while the unit is on, the last usage setting before disconnecting the AC power cord (mains lead) is not kept. Turn off the power of the unit, and then unplug the AC power cord (mains lead).

The unit has entered standby mode or BLUETOOTH/Network standby mode unexpectedly

- ➔ This is not a malfunction. The unit enters standby mode or BLUETOOTH/Network standby mode automatically due to the auto standby function if no operation is performed and no sound is input for about 15 minutes. Refer to Help Guide for details about the auto standby function.

To check Wi-Fi signal strength (reception sensitivity)

While the unit is connected to the Wi-Fi network, tap and hold the NETWORK button until you hear a beep.

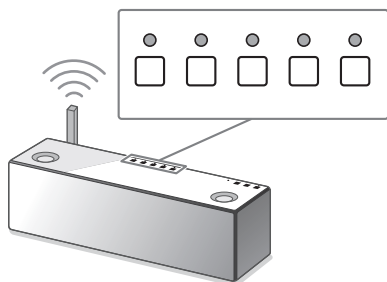

	5	●	●	●	●	●
	4	●	●	●	●	○
	3	●	●	●	○	○
	2	●	●	○	○	○
	1	●	○	○	○	○
	0	○	○	○	○	○
Signal strength	Number of flashing function indicators					

Flashing stops when any button is tapped. To receive a stronger signal, try the following:

- Change the direction of the Wi-Fi antenna (aerial).
- Turn off other wireless devices.

To use the BLUETOOTH/Network standby function

If the BLUETOOTH/Network standby function is on, the unit turns on automatically by operating a BLUETOOTH device or network device, even if the unit is turned off. The unit will start up more quickly than usual.

- 1 Make sure the unit is turned on. Tap and hold the I/⏻ (on/standby) button until it lights up in orange.**

The unit turns off and enters the BLUETOOTH/Network standby mode. If you operate a BLUETOOTH device or network device, the unit turns on automatically and connection starts.

To initialize the unit

Initialize the unit if these measures do not resolve the problem or if the settings fail.

- 1 Make sure the unit is turned on. Tap and hold both the VOL (volume) – button**

and I/⏻ (on/standby) button at the same time for more than 5 seconds.

The unit will turn off. Settings will return to their factory defaults, and all BLUETOOTH pairing information and network settings will be reset.

Note

If you initialize the unit, the unit may not be able to connect your iPhone/iPad/iPod or PC. In this case, erase the pairing information on the iPhone/iPad/iPod or PC, and then perform the pairing procedure again.

- ▶ Refer to Help Guide for symptoms other than the above.

http://rd1.sony.net/help/speaker/srs-x99/h_zz/



What is BLUETOOTH wireless technology?

BLUETOOTH wireless technology is a short-range wireless technology that enables wireless data communication between digital devices, such as a computer and digital camera. BLUETOOTH wireless technology operates within a range of about 10 m.

Connecting two devices as necessary is common, but some devices can be connected to multiple devices at the same time.

You do not need to use a cable for connection, nor is it necessary for the devices to face one another, such is the case with infrared technology. For example, you can use such a device in a bag or pocket. BLUETOOTH standard is an international standard supported by thousands of companies all over the world, and employed by various companies worldwide.

Maximum communication range

Maximum communication range may shorten under the following conditions.

- There is an obstacle such as a person, metal, or wall between the system and BLUETOOTH device.
- A wireless LAN device is in use near the system.
- A microwave oven is in use near the system.
- A device that generates electromagnetic radiation is in use near the system.

Interference from other devices

Because BLUETOOTH devices and wireless LAN (IEEE802.11b/g/n) use the same frequency, microwave interference may occur and resulting in communication speed deterioration, noise, or invalid connection if the system is used near a wireless LAN device. In such a case, perform the following.

- Use the system at least 10 m away from the wireless LAN device.

- If the system is used within 10 m of a wireless LAN device, turn off the wireless LAN device.

Interference to other devices

Microwaves emitting from a BLUETOOTH device may affect the operation of electronic medical devices. Turn off the system and other BLUETOOTH devices in the following locations, as it may cause an accident.

- where inflammable gas is present, in a hospital, train, airplane, or a gas station
 - near automatic doors or a fire alarm
- To be able to use the BLUETOOTH function, the BLUETOOTH device to be connected requires the same profile as the system's. Note also that even if the same profile exists, devices may vary in function depending on their specifications.
 - Due to the characteristic of BLUETOOTH wireless technology, the sound played on the system is slightly delayed from the sound played on the BLUETOOTH device during talking on the telephone or listening to the music.
 - This system supports security capabilities that comply with the BLUETOOTH standard to provide a secure connection when the BLUETOOTH wireless technology is used, but security may not be enough depending on the setting. Be careful when communicating using BLUETOOTH wireless technology.
 - We do not take any responsibility for the leakage of information during BLUETOOTH communication.
 - A device featuring the BLUETOOTH function is required to conform to the BLUETOOTH standard specified by Bluetooth SIG, and be authenticated. Even if the connected device conforms to the above mentioned BLUETOOTH standard, some devices may not be connected or work correctly, depending on the features or specifications of the device.
 - Noise or sound skips may occur depending on the BLUETOOTH device connected with the system, the communication environment or the usage environment.

Specifications

Section for Speaker

Speakers

Super tweeter (Top): Approx. 19 mm diameter × 2
Super tweeter (Front): Approx. 19 mm diameter × 2
Midrange: Approx. 50 mm diameter × 2
Subwoofer: Approx. 94 mm diameter × 1

Section for Amplifier

POWER OUTPUT AND TOTAL HARMONIC DISTORTION:

Power Output (reference)

Super tweeter (Top): 2 W × 2 (at less than 10 % harmonic distortion, 20 kHz)
Super tweeter (Front): 25 W × 2 (at less than 10 % harmonic distortion, 10 kHz)
Midrange: 25 W × 2 (at less than 10 % harmonic distortion, 1 kHz)
Subwoofer: 25 W × 2 (at less than 10 % harmonic distortion, 100 kHz)

Section for Network

Compatible standards

IEEE 802.11 a/b/g/n (WEP 64 bit, WEP 128 bit, WPA/WPA2-PSK (AES), WPA/WPA2-PSK (TKIP))

Radio frequency

2.4/5 GHz band

Section for BLUETOOTH

Output

BLUETOOTH Specification Power Class 2

Maximum communication range

Line of sight Approx. 10 m^{*1}

Radio frequency

2.4 GHz band (2.4000 GHz – 2.4835 GHz)

Communication System

BLUETOOTH Specification Version 3.0

Compatible BLUETOOTH Profiles^{*2}

A2DP (Advanced Audio Distribution Profile) / AVRCP (Audio Video Remote Control Profile)

Supported codec^{*3}

SBC^{*4} / AAC^{*5} / LDAC^{*6}

Transmission bandwidth (A2DP)

20 Hz – 20,000 Hz (with 44.1 kHz sampling)

^{*1} The actual range will vary depending on factors such as obstacles between devices, magnetic fields around a microwave oven, static electricity, reception sensitivity, aerial's performance, operating system, software application, etc.

^{*2} BLUETOOTH standard profiles indicate the purpose of BLUETOOTH communication between devices.

^{*3} Codec: Audio signal compression and conversion format

^{*4} Subband Codec

^{*5} Advanced Audio Coding

^{*6} LDAC is an audio coding technology developed by Sony that enables the transmission of High-Resolution (Hi-Res) Audio content, even over a BLUETOOTH connection. Unlike other BLUETOOTH compatible coding technologies such as SBC, it operates without any down-conversion of the Hi-Res Audio content^{*7}, and allows approximately three times more data^{*8} than those other technologies to be transmitted over a BLUETOOTH wireless network with unprecedented sound quality, by means of efficient coding and optimized packetization.

^{*7} Excluding DSD format contents

^{*8} In comparison with SBC (Subband Coding) when the bitrate of 990kbps (96/48kHz) or 909kbps (88.2/44.1kHz) is selected

Section for USB port

USB A port (A)

You can connect a USB flash drive, Walkman®, or iPhone/iPad/iPod that is compatible with this unit.

Supported format^{*1}

MP3: 32/44.1/48 kHz, 16 - 320 kbps (CBR/VBR)
AAC: 32/44.1/48/88.2/96 kHz, 16 - 320 kbps (CBR/VBR)
WMA: 32/44.1/48 kHz, 16 - 320 kbps (CBR/VBR)
WAV: 32/44.1/48/88.2/96/176.4/192 kHz (16/24 bit)
AIFF: 32/44.1/48/88.2/96/176.4/192 kHz (16/24 bit)
FLAC: 32/44.1/48/88.2/96/176.4/192 kHz (16/24 bit)

ALAC: 32/44.1/48/88.2/96/176.4/192 kHz
(16/24 bit)
DSD (DSF/DSDIFF): 2.8 MHz (1 bit)

Transfer speed

High-speed

Supported USB device

Mass Storage Class (MSC)

Maximum output current

2.1 A MAX

USB B port (←B)

You can connect a compatible device such as a PC, etc., to this unit using a USB cable (not supplied).

Supported format*¹

PCM: 44.1/48/88.2/96/176.4/192 kHz (16/
24/32bit)
DSD (DSF/DSDIFF): 2.8 MHz (1bit)

*¹ Compatibility with all encoding/writing software, recording devices and recording media cannot be guaranteed.

General

AUDIO IN

ANALOG Φ 3.5 mm stereo mini jack

Network port

10BASE-T/100BASE-TX (Auto Polarity)

Power requirements

220 V - 240 V AC, 50 Hz/60 Hz

Power consumption

50 W

Power consumption (during standby mode)

Less than 0.5 W

Power consumption (during BLUETOOTH/ network standby mode)

Less than 6 W

Operating temperature

5 °C to 35 °C

Dimensions (w/h/d) (including projecting parts and controls)

Approx. 430 mm × 133 mm × 125 mm

Mass

Approx. 4.7 kg

Supplied accessories:

Remote control (RMT-CX9) (1)
AC power cord (mains lead) (2)
AAA size batteries for the remote control (2)

Cleaning cloth (1)
Speaker grille detach tool (2) (page 9)
Wi-Fi Startup Guide
Operating Instructions (this document)
Warranty card (1)

For customers in the UK, Ireland, Malta, Cyprus, and Hong Kong:

Use the AC power cord (mains lead) (A). For safety reasons, the AC power cord (mains lead) (B) is not intended for the above countries/regions and shall therefore not be used there.

For customers in other countries/regions: Use the AC power cord (mains lead) (B).

(A)

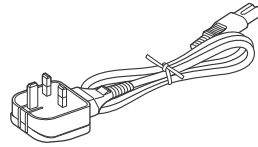

(B)

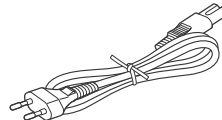

The AC power cord (mains lead) (B) is not supplied for customers in Hong Kong.

Design and specifications are subject to change without notice.

Compatible iPhone/iPad/iPod models

Compatible models	AirPlay	BLUETOOTH	USB
iPhone 6 Plus	✓	✓	✓
iPhone 6	✓	✓	✓
iPhone 5s	✓	✓	✓
iPhone 5c	✓	✓	✓
iPhone 5	✓	✓	✓
iPhone 4s	✓	✓	✓
iPhone 4	✓	✓	✓
iPhone 3GS	✓	✓	✓
iPad Air 2*	✓	✓	✓
iPad mini 3*	✓	✓	✓
iPad Air*	✓	✓	✓
iPad mini 2*	✓	✓	✓
iPad (4th generation)*	✓	✓	✓
iPad mini*	✓	✓	✓
iPad (3rd generation)*	✓	✓	✓
iPad 2*	✓	✓	✓
iPad*	✓	✓	✓
iPod touch (5th generation)	✓	✓	✓
iPod touch (4th generation)	✓	✓	✓
iPod touch (3rd generation)*	✓	✓	✓
iPod classic*			✓
iPod nano (7th generation)*		✓	✓
iPod nano (6th generation)*			✓
iPod nano (5th generation)*			✓
iPod nano (4th generation)*			✓

* SongPal does not support iPod touch (3rd generation), iPod classic, and iPod nano.

SongPal, as of January 2015, does not support the display optimized for iPad screen.

AirPlay works with iPhone, iPad, and iPod touch with iOS 4.3.3 or later, Mac with OS X Mountain Lion or later, and Mac and PC with iTunes 10.2.2 or later.

Note

Sony cannot accept responsibility in the event that data recorded to iPhone/iPad/iPod is lost or damaged when using your iPhone/iPad/iPod connected to this unit.



* 4 5 6 7 5 0 3 2 3 * (2)